

HOW TO ASSIGN A KEYBOX TO YOUR LISTING

Mastering your keybox system improves property access management. Assigning a keybox to a specific listing ensures that all communications from the box display the property address rather than a generic label, making it easier to track and manage access seamlessly.

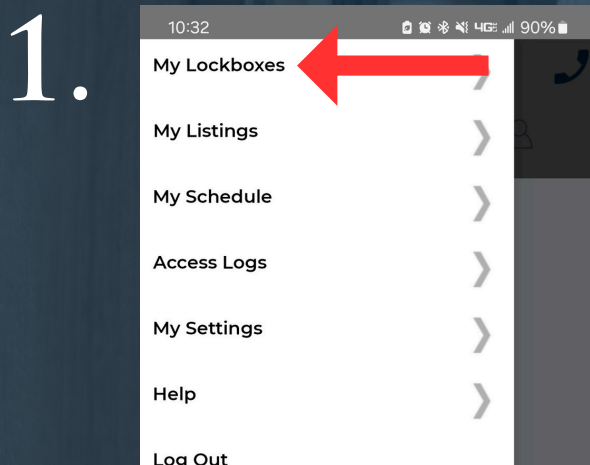

Open the menu by tapping the three horizontal bars at the app's upper right. Then choose "My Lockboxes".

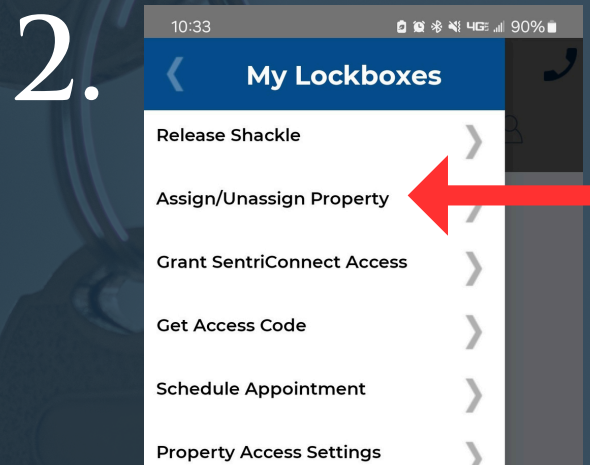

Select "Assign/Unassign Property".

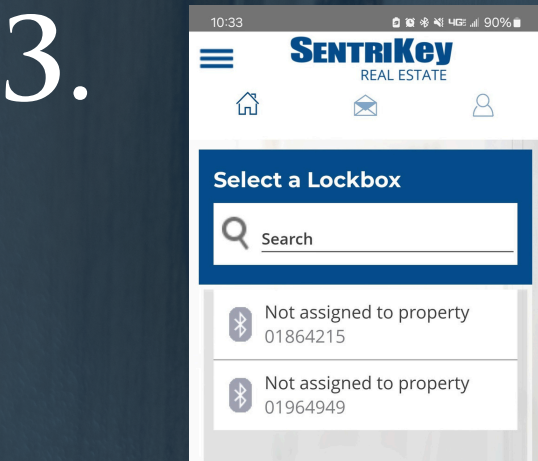

Choose the correct keybox from the serial numbers or enter the serial number to search.

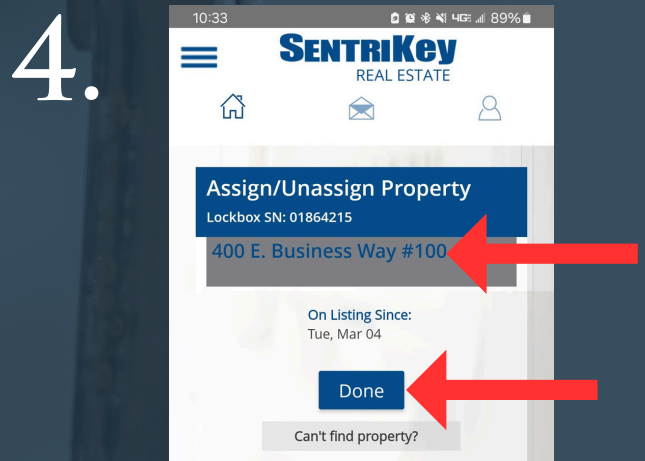

Select the desired property and tap "Done".